



AL601F 2.0

Basic model for small and medium-size doors

The basic model of SCHNEIDER aluminium folding doors AL601F 2.0 is a good option for smaller doors with lower frequency. SCHNEIDER aluminium folding doors are space-saving, and hardly any maintenance and upkeep costs are incurred, since a solid folding door has practically no wear-parts.

The possibility to individually design the door with numerous colours and patterns, among others the popular sun motif, makes SCHNEIDER folding doors also interesting for agricultural farmsteads and private properties.

HIGHLIGHTS

- › Lightweight, stable design
- › High-tech material
- › Design depth: 60 mm
- › Area of application up to 10.4 m in width x 4.8 m in height
- › Screw- and plug-type connections



Technical data	AL601F 2.0
Design depth	60 mm
Frame width	min. 87 mm
max. door size (OW x OH)	10,400 x 4,800 mm
max. leaf width	1,300 mm
Partition variants	2+0 / 2+1 / 2+2 / 3+0 / 3+1 / 3+2 / 3+3 / 4+0 / 4+1 / 4+2 / 4+3 / 4+4
Door with active leaf (OW x OH)	5,500 x 3,500 mm
Built-in access door	max. height 2,500 mm
Insulating safety glass	max. 2 m ² per leaf
Automatic opening	possible with partition 2+2
Resistance against wind load	min. Class 2-5
Watertightness	Class 0-3
Airtightness	Class 0-3
Thermal resistance	on request
Fire protection	Class 0
Motion cycles	150,000



DOOR DESIGN AL601F 2.0

Stable aluminium frame design

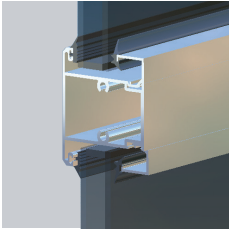

Profile

- › Design depth: 60 mm
- › Frame width: min. 87 mm
- › Wall thickness of the profiles: min. 2-4 mm
- › Frame anodised with A6/C0 or high-quality powder coating possible

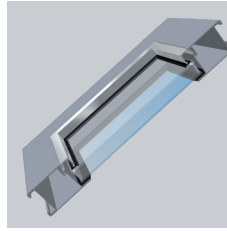

Fillings

- › Double-walled panels
 - + Aluminium panels: 42 mm
 - + Steel ISO panels: 40 mm
- › Double-walled glazing or multi-skin sheets in different variants and thicknesses



Colour

- › Anodised with A6/C0
- › Powder coating in façade quality or highly weather-resistant
 - + RAL at customer's choice
 - + Metallic
 - + Wood décor



Operation

- › Manual
- › Fast automatic opening
- › E-drive Basic

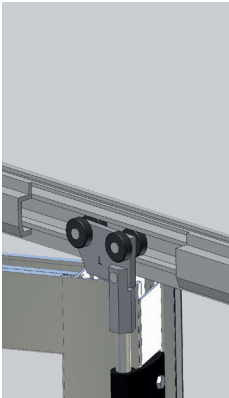

Running rail

- › Of 5 mm thick aluminium profile anodised with A6/C0 or coated
- › Steel rail with 180° opening
- › Suspension of the door leaves on roller units with horizontal and vertical guide rollers
- › Integrated seal carrier with continuous lip sealing
- › Dust-proof, maintenance-free ball bearings
- › Opening angle: 90° or 180° (max. 3 leaves)
- › Rail remains clean, as it is only open towards the bottom
- › Ease of operation and smooth running



Hinges

- › Hinge bolt stainless steel 16 mm
- › Hidden screwed aluminum hinges anodised with C35
- › Dust-proof thrust bearing between the hinge straps
- › Solid, adjustable, re-forgeable
- › Ease of operation, easy to replace, easily re-adjustable, no wear



Finger-pinch protection

Safety with finger-pinch protection made of elastic non-decomposable EPDM rubber in all vertical closing edges, black

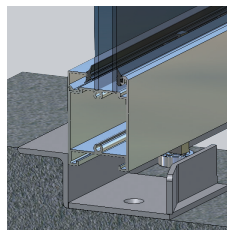

Floor connection

- › Galvanised as standard
- › Threshold: L50 (Fig.), L50 NIRO, L50D, U50D
- › Without threshold: RA
- › Recessed floor guide: BF-light NIRO, BF-light NIRO heated
- › Threshold S10 with single seal



Integrated door

- › Fast access to the hall without having to open the entire folding door.
- › Active leaf: entire door leaf with access function
- › Built-in access door: opening towards the outside with max. height 2,500 mm,
- › Threshold profile: max. 40 mm, low threshold* possible

*only with floor connection with tread angle and without rubber seal