



AL603F/SF

Energy efficiency, brightness and elegance

SCHNEIDER's AL603F aluminium folding door / SF consists of specially designed thermally separated profiles that result in much better thermal insulation than regular profiles. The AL603F/SF profiles are joined to a door with high torsional stability using a screw and plug system. Just like AL602F/SF, solid running rails, hinges and corner connectors further boost its durability, thus allowing for large glazed surfaces.

HIGHLIGHTS

- › Thermally separated aluminium profile
- › Triple glazing, U-value 1.4 W/m²K
- › Triple glazing up to 2,400 mm glass height
- › Applicable up to widths of 15.6 x 5.6 m height
- › Reinforced glue joints in frame corners
- › Car wash box: Pre-anodised for corrosion protection and powder-coated aluminium doors

Technical data	AL603F/SF
Installation depth	60 mm
Frame width:	min. 87 mm
Max. door size (ordered width x ordered height)	15,600 x 5,600 mm
Max. wing width	1,300 mm
Split versions	2+0 / 2+1 / 2+2 / 3+0 / 3+1 / 3+2 / 3+3 / 4+0 / 4+1 / 4+2 / 4+3 / 4+4 / 5+0 / 5+1 / 5+2 / 6+0 / 6+1 / 6+2 / 6+4 / 6+6
Door with step-through wing (ordered width x ordered height)	5 500 x 3 000 mm
Installed pedestrian door	Max. height 2,500 mm
Continuous glazing	On even split up to ordered height 4000 mm
Automatic opening function	Possible on 2+2 split
Resistance to wind load	At least class 2-4
Air tightness	Class 0-4
RC2 resistance class	Optional
Heat resistance	on request
Fire protection	Class 0
Motion cycles	200,000
Sound insulation value	Up to 35 dB

Our doors are manufactured to meet your requirements. Therefore the information above varies depending on the specific door design.



AL603F/SF DOOR DESIGN

Sturdy aluminium frame design with high joint strength and extremely strong corner connectors and thermal separation

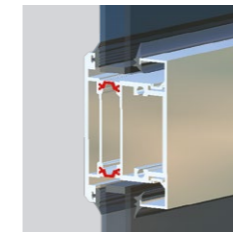

Profile

- › thermally separated
- › Installation depth: 60 mm
- › Frame width: at least 87 mm
- › Wall thickness of the profiles: at least 2-4 mm

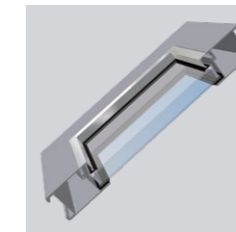

Infills

- › Double-wall aluminium panels
- › Double and/or triple glazing or multi-skin sheets in various designs and thicknesses



Colour

- › A6/C0 anodised
- › Facade quality or highly weather-proof powder-coating + RAL at customer's choice
- › Metallic



Operation

- › Manual
- › Automatic quick opening – system
- › Basic electric drive system or the Power-F system

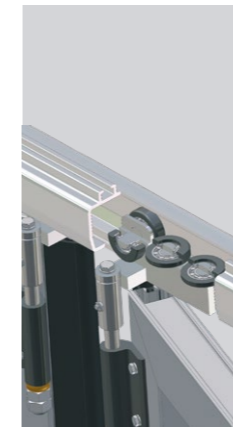

Running rail

- › Made from 5-mm-thick A6/C0 aluminium profile or coated
- › Steel rails on 180-degree opening version
- › Door wings suspended on door slide mechanisms with horizontal and vertical guide roll-ups
- › Built-in seal carrier with continuous lip seal
- › Dust-proof, maintenance-free ball bearings
- › Opening angle: 90° or 180° (max. 3 wings)
- › Rail remains clean as it is only open at the bottom
- › Smooth and quiet operation



Belts

- › Stainless steel 20 mm hinge bolts
- › Concealed aluminium hinges, C35 anodised
- › Dust-proof thrust bearings between hinge straps
- › Solid, adjustable, re-greasable
- › Smooth operation, simple to change, easy to re-adjust, no wear

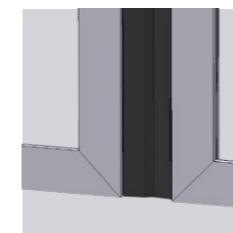

Finger pinch protection

Safety is provided by finger pinch protection made of elastic, non-degrading EPDM rubber in all vertical closing edges, black

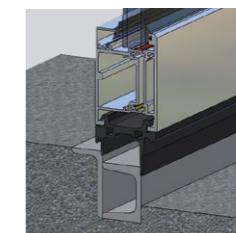

Ground seal

- › Galvanised as standard
- › Threshold: Double bracket (Fig.), L50D, L50D stainless steel, U50D
- › Flush floor guide: BF, BF heated, BF-light stainless steel, BF-light stainless steel heated
- › S20D Threshold with dual lip seal



Integrated door

- › Access the hall quickly without having to open the entire door
- › Pedestrian wing: full-size door wing with pedestrian function
- › Built-in pedestrian door: opening outwards at max. height 2,500 mm
- › Threshold profile: max. 40 mm, low-profile threshold possible